



cromox[®]

PREMIUM BRAND OF KETTEN WÄLDER GMBH

USER MANUAL

cromox[®] HOIST TROLLEY



Hoist Trolley CHT
Grade 60, AISI 316L

TABLE OF CONTENTS

1. IMPORTANT INFORMATION AND SAFETY WARNINGS	4
1.1. TERMINOLOGY AND OVERVIEW	4
2. TECHNICAL DATA	4
2.1. DIMENSIONS	4
2.2. ENVIRONMENTAL CONDITIONS	5
3. PRE-USE INSPECTIONS	5
3.1. CHECKLIST	5
4. OPERATION GUIDELINES	6
4.1. DOS AND DON'TS DURING OPERATION	6
4.2. OPERATING PROCEDURES	6
5. INSPECTION AND TESTING	6
5.1. DAILY INSPECTION	6
5.2. PERIODIC INSPECTIONS	7
6. MAINTENANCE AND CARE	8
7. TROUBLESHOOTING	9
8. WARRANTY DETAILS	10
9. SCOPE OF DELIVERY	10
10. MAINTENANCE RECORD DATA SHEET	11

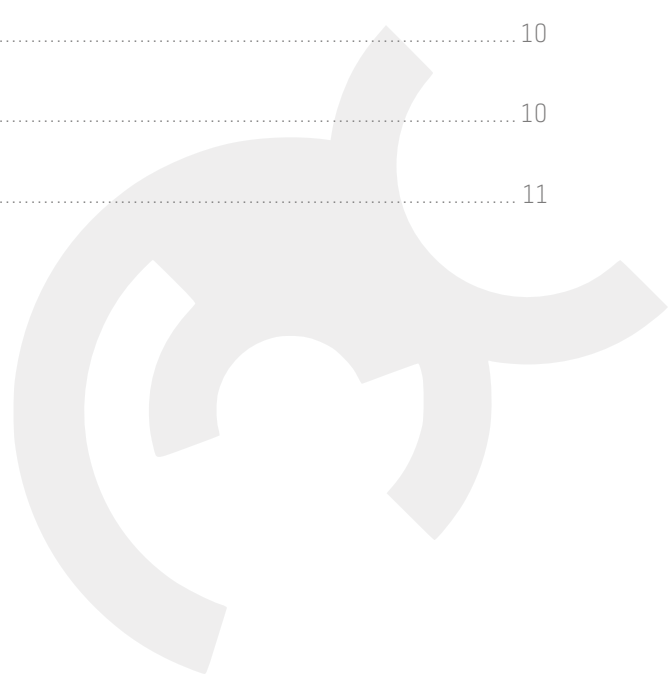

1. IMPORTANT INFORMATION AND SAFETY WARNINGS

1.1. TERMINOLOGY AND OVERVIEW

WLL (Working Load Limit)

Indicates the maximum weight the trolley is designed to support safely during general use.

Danger Levels



CAUTION This points out a situation that could be dangerous but may only result in minor or moderate injury or property damage if not handled properly.



WARNING This indicates a potentially hazardous situation which, if not avoided, could lead to death or severe injury and property damage.



DANGER This indicates a situation that is extremely hazardous and, if not avoided, will lead to death or severe injury and property damage.

NOTICE This provides important information regarding installation, operation, or maintenance, which is not directly related to safety.



CAUTION

Ignoring any of the specified limitations in this document may result in serious bodily harm or death, and/or property damage.

Always use authorized cromox® replacement parts and don't perform any modifications to the product without the manufacturer's approval.

2. TECHNICAL DATA

2.1. DIMENSIONS

Ensure the working environment meets the necessary conditions, and verify the trolley dimensions are suitable for the equipment and rail system before installation.

Type	WLL [t]	Dimensions [mm]									Weight [kg, approx.]
		a	x	b	c	d	e	f	s	p	
CHT	0.63 - 2.00	210	x	x + 100	164	40	28	11	10	83	7.0 - 8.5
CHT geared	0.63 - 2.00	210	x	x + 100	188	40	28	11	10	83	10.0

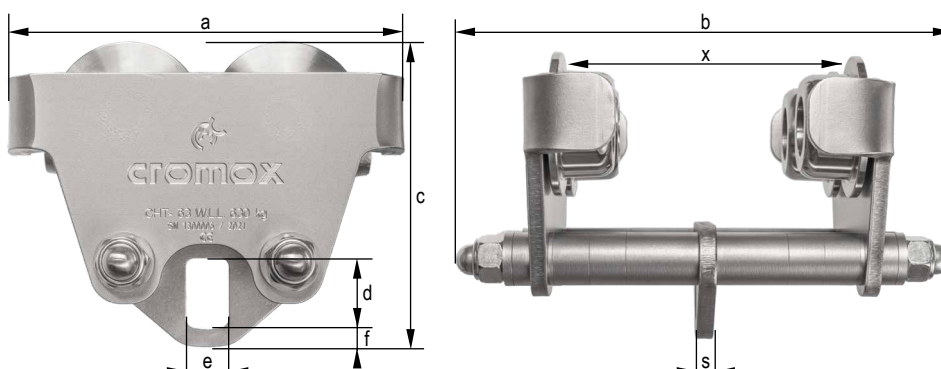

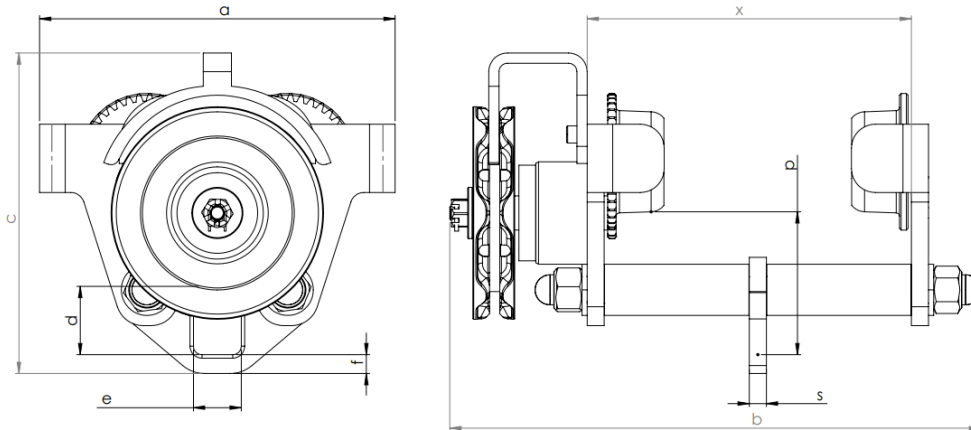

2.2. ENVIRONMENTAL CONDITIONS

- Ambient temperature: -40 to +60 °C
- Application in corrosive environment possible
- Maximum relative humidity: 100 %
- Application in ex zone after consultation with manufacturer
- Tested acc. to DIN EN 13157

3. PRE-USE INSPECTIONS



WARNING

Transporting heavy loads presents a significant risk, especially if the equipment is used improperly or not maintained correctly. To prevent accidents and serious injuries, strict safety measures must be followed during the operation, maintenance, and inspection of the cromox® Hoist Trolley CHT.

Inspect the product for any damage upon delivery, and never install or use a damaged trolley. Keep records of all product information and report any issues to your cromox® dealer. Always refer to relevant codes and regulations before installing the equipment.

3.1. CHECKLIST

- **NEVER** use the trolley to transport people.
- **NEVER** move loads over or near people.
- **NEVER** exceed the WLL (Working Load Limit) indicated on the nameplate.
- **ALWAYS** inform those around you when transporting a load.
- **ALWAYS** read and follow the operation and safety instructions.

NOTICE

It is the operator's responsibility to handle the trolley safely. Ensure compliance with all relevant safety codes, regulations, and laws when using the equipment.



4. OPERATION GUIDELINES

4.1. DOS AND DON'TS DURING OPERATION



CAUTION

- Always alert others when starting a transport.
- Stop immediately if any abnormalities are detected, and report failures for repair.
- Never use the trolley for transporting people or exceeding the WLL.
- Ensure the load remains centered and stable while operating.

4.2. OPERATING PROCEDURES

NOTICE

Before use:

- Wear personal protective equipment.
- Check that the beam width fits the trolley and that the nameplate is visible.

After operation:

- Do not leave suspended loads unattended.
- Store the trolley in a dry location when not in use.

General:

- Regularly inspect the trolley to ensure all safety warnings are intact and visible.
- The trolley is designed for horizontal transport of loads under standard conditions.

5. INSPECTION AND TESTING

NOTICE

There are two main types of inspection:

1. **Daily inspection:** Conducted by the operator before each use.
2. **Periodic inspection:** A more detailed examination, performed by qualified personnel authorized to take the trolley out of service if necessary.

5.1. DAILY INSPECTION

Before every shift, the operator must check the following:

Functionality (geared trolley):

- Run the trolley without a load and listen for irregular noises.
- The trolley should move smoothly and remain level under light load conditions.



- If movement is not smooth or noises are heard, identify the issue and replace the trolley if needed. Additionally, repair or replace the hand chain if necessary. Safety factors: WLL 1 x, MPF 2.5 x, BF 4 x

Wear, deformation, or damage:

- Visually inspect all parts for signs of wear, deformation, or damage.
- Replace any worn, deformed, or damaged parts with new ones.

Part loosening:

- Check visually to ensure no parts are loose.
- Tighten any loose parts securely.

Name plate:

- Ensure the name plate is clear and fully legible.

Missing parts:

- Visually check for any missing nuts, bolts, or circlips.
- Replace any missing components promptly.

5.2. PERIODIC INSPECTIONS

Periodic inspections should be performed according to the following intervals and procedures:

- **Normal use:** Semiannual inspection
- **Heavy use (frequent operation):** Quarterly inspection
- **Severe use (excessively frequent operation):** Monthly inspection

In addition to the daily inspection tasks, the following items must also be checked during periodic inspections:

Inspection methods | criteria | action**1. Traversing function:**

- Move the trolley with a light load.
- The trolley should move smoothly and stay level under the load.
- If movement is not smooth, adjust the beam or rebalance the trolley as needed.

2. Side plate deformation:

- Use calipers to check for any deformation.

3. Beam deformation:

- Visually inspect or use calipers to check for deformation in the beam flange.
- Replace or repair the beam if deformation is detected.

4. Condition of wheels:

- Visually check that the trolley wheels align properly with the beam.
- Adjust or repair as needed.



5. Loosening of fixing bolts:

- Use a spanner to check if bolts are securely tightened.
- Tighten any loose bolts.

6. Missing nuts or circlips:

- Visually inspect for missing components.
- Replace any missing parts.

7. Hand wheel damage:

- Check visually for damage.
- Never use a damaged hand wheel; replace it immediately.

8. Gear deformation and wear:

- Visually inspect or use calipers to check for wear or deformation.
- Never use deformed or worn gears; replace them promptly.

Operators should visually inspect the trolley regularly for any signs of wear, damage, cuts, cracks, or corrosion. If any issues are found, the trolley should be removed from service until it has been properly repaired. Only use cromox® replacement parts. Perform a monthly check on the suspension plate, track wheel, and locking nuts to ensure all nuts are securely fastened.

6. MAINTENANCE AND CARE



CAUTION

1. **NEVER** perform maintenance on the trolley while it is supporting a load.
2. Before starting maintenance, attach a clear tag stating: "**DANGER: NEVER OPERATE EQUIPMENT BEING REPAIRED.**"
3. Only qualified service personnel should carry out maintenance.
4. After any maintenance work, **ALWAYS** test the trolley at its Working Load Limit (WLL) before returning it to service.
5. Ensure replacement parts are only cromox® components.

When performing inspections:

- **ALWAYS** indicate "CHECKING" during an inspection.
- **ALWAYS** wear appropriate protective equipment such as goggles and gloves based on the work being performed.
- **ALWAYS** follow proper work methods, procedures, and maintain a safe posture.
- **ALWAYS** wear a helmet and safety belt for high-lift tasks.
- **ALWAYS** clean any oil or grease from the product or the floor to avoid accidents.
- **ALWAYS** keep the work area clean when disassembling the product.
- **ALWAYS** ensure that hands or clothing do not get caught in the track wheel or any moving parts.



Trolley storage:

- NEVER expose the trolley to rain or moisture.
- ALWAYS wipe off any dirt or water before storing.
- ALWAYS store the trolley in a dry place.

Inspections should be performed by a competent person at intervals of no more than 12 months. If necessary, these intervals should be shortened in dependence of the circumstances of use. Any cleaning method that does not attack the basic material is admissible, whereas any processes or procedures that may cause overheating or material abrasion or which may hide surface damage are to be avoided. Sufficient lighting is to be provided during inspections, and all components of the chain sling are to be examined. By means of visual inspections, the chain slings are to be checked for unmistakable identification (tags) as well as for any visually noticeable defects.

If any of the following defects are found, the hand chain has to be removed from operation and inspected by a competent person or serviced/repared:

- Deformation of suspension or sling parts.
- Inadmissible elongation of chain links.
- If, as a result of wear and tear, the nominal thickness of a chain link is < 90% [see Fig. 2].

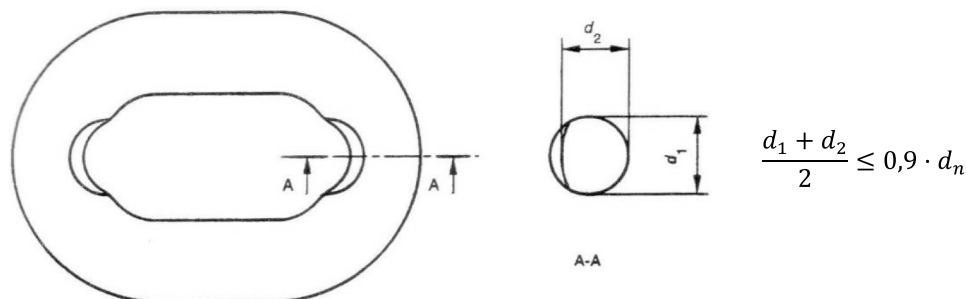

- Damage [cuts, notches, grooves, cracks, discoloration due to heat, excessive corrosion, bent or twisted links, or other defects].
- Inspections are to be recorded and praved in writing.

7. TROUBLESHOOTING



CAUTION

The following guide addresses common issues. If the problem persists, consult a qualified technician or contact the manufacturer for assistance:

Problem	Possible cause	Solution
Stuck Castors	Broken bearing or dirt	Clean the trolley or replace the broken bearing.
Excessive Noise during Operation	Worn-out gears or bearings	Inspect and replace any worn-out parts.
Chain Slips or Binds	Misaligned sheaves or guides	Correctly align the components to prevent binding.
Bent or Damaged Chain	Misalignment or damage	Repair or replace the chain to ensure smooth operation.

If further assistance is needed, always reach out to a professional to avoid potential damage or safety risks.

8. WARRANTY DETAILS

cromox® trolleys come with a standard warranty that covers defects in materials and workmanship. Please review the following conditions and exclusions:

Warranty duration: The standard warranty is valid for 12 months from the date of purchase.

Filing a claim: To file a warranty claim, contact the retailer or distributor where the trolley was purchased. Make sure to provide proof of purchase and a detailed description of the issue.

Warranty coverage: The warranty covers both parts and labor for repairs related to manufacturing defects. It does not cover damages resulting from misuse, neglect, or unauthorized modifications.

Exclusions: The warranty does not cover:

- Normal wear and tear.
- Damage due to misuse or neglect.
- Unauthorized alterations.
- Issues caused by improper maintenance.

9. SCOPE OF DELIVERY

Standard scope of delivery:

- Mounted CHT trolley or geared trolley including handchain
- User manual

Additional information

Contact information:

For additional support, please reach out to your cromox® authorized dealer or contact our customer service team at:

Email: info@ketten-waelder.de

Phone: +49 (0)8053 2029-0

Website: www.ketten-waelder.de



10. MAINTENANCE RECORD DATA SHEET

	Maintenance date ▼	Performed by ▼	Next scheduled maintenance ▼	Signature ▼
Inspection type ▶				
Components inspected ▶				
Findings/issues ▶				
Action taken ▶				
Inspection type ▶				
Components inspected ▶				
Findings/issues ▶				
Action taken ▶				
Inspection type ▶				
Components inspected ▶				
Findings/issues ▶				
Action taken ▶				
Inspection type ▶				
Components inspected ▶				
Findings/issues ▶				
Action taken ▶				



	Maintenance date ▼	Performed by ▼	Next scheduled maintenance ▼	Signature ▼
Inspection type ▶				
Components inspected ▶				
Findings/issues ▶				
Action taken ▶				

	Maintenance date ▼	Performed by ▼	Next scheduled maintenance ▼	Signature ▼
Inspection type ▶				
Components inspected ▶				
Findings/issues ▶				
Action taken ▶				

	Maintenance date ▼	Performed by ▼	Next scheduled maintenance ▼	Signature ▼
Inspection type ▶				
Components inspected ▶				
Findings/issues ▶				
Action taken ▶				

	Maintenance date ▼	Performed by ▼	Next scheduled maintenance ▼	Signature ▼
Inspection type ▶				
Components inspected ▶				
Findings/issues ▶				
Action taken ▶				



	Maintenance date ▼	Performed by ▼	Next scheduled maintenance ▼	Signature ▼
Inspection type ▶				
Components inspected ▶				
Findings/issues ▶				
Action taken ▶				
Inspection type ▶				
Components inspected ▶				
Findings/issues ▶				
Action taken ▶				
Inspection type ▶				
Components inspected ▶				
Findings/issues ▶				
Action taken ▶				

Maintenance task details

Performed by: Name of the person conducting the inspection or maintenance.

Inspection type: Indicate whether it's a Daily, Periodic, or Special inspection.

Components inspected: List the parts inspected [e.g., chain, wheels, rails, bolts].

Findings/issues: Note any issues discovered during the inspection.

Action taken: Detail any repairs or adjustments made.

Next scheduled maintenance: Indicate the date for the next maintenance or inspection.

Signature: Signature of the person performing the maintenance for accountability.



KETTEN WÄLDER GMBH
IM GEWERBEGBIET 5
83093 BAD ENDORF
GERMANY

+49 (0)8053 2029-0
INFO@KETTEN-WAELDER.DE

KETTEN-WAELDER.DE